

PLAN SHOWING THE PROPOSED SUB DIVISION AT PLOT No 104, SNo 33/2,  
 PADMANABHA NAGAR, HASTHINAPURAM VILLAGE, SAIDAPET TALUK, CHENGLEPUT  
 DISTRICT.

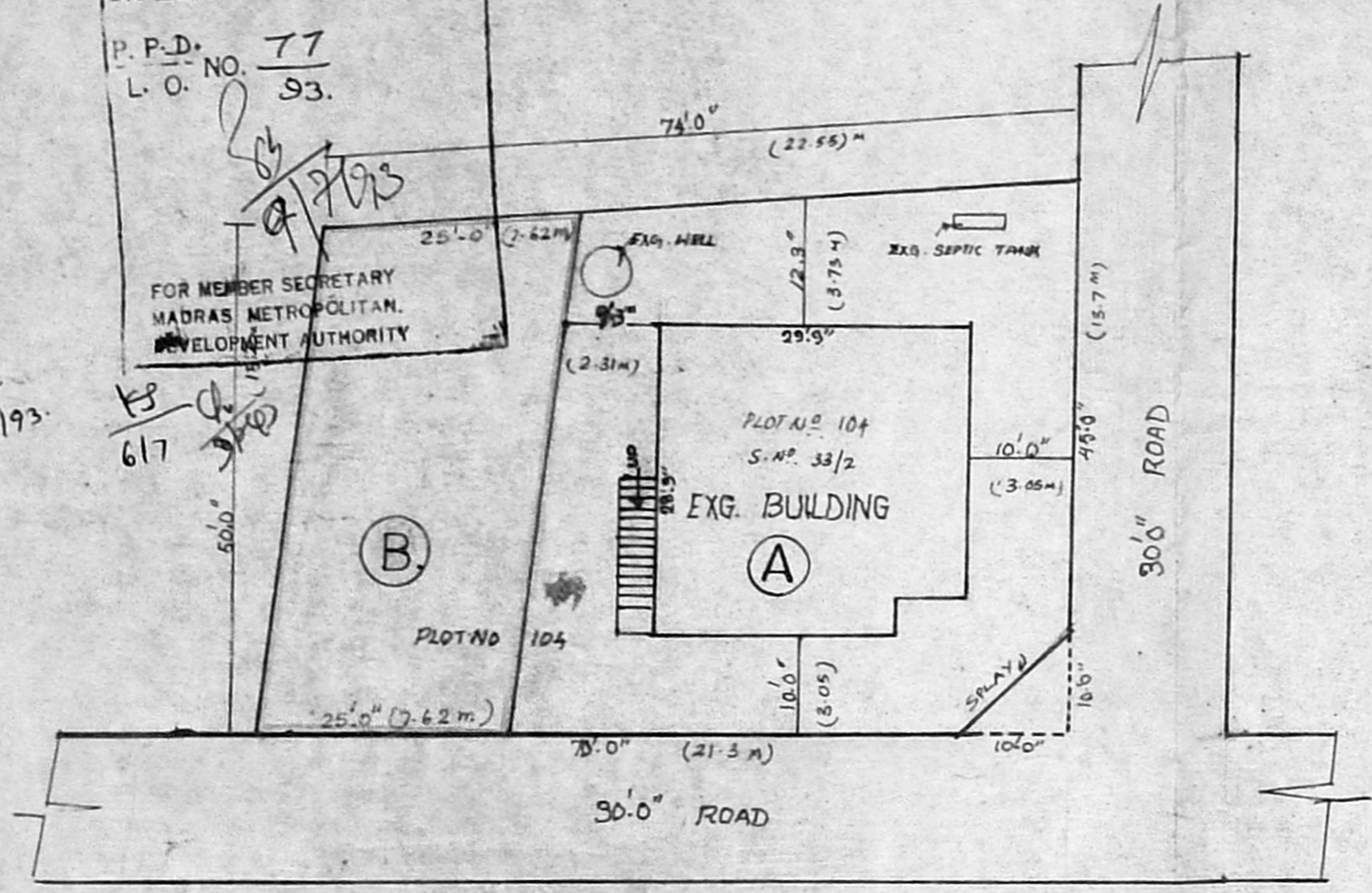

**APPROVED**  
 WIDE LR. NO. L1/12896/93  
 DTD 9.7.93.  
 P.P.D. NO. 77  
 L.O. NO. 93.  
 FOR MEMBER SECRETARY  
 MADRAS METROPOLITAN  
 DEVELOPMENT AUTHORITY

R  
 6/7/93.



SITE PLAN SCALE 1:200.

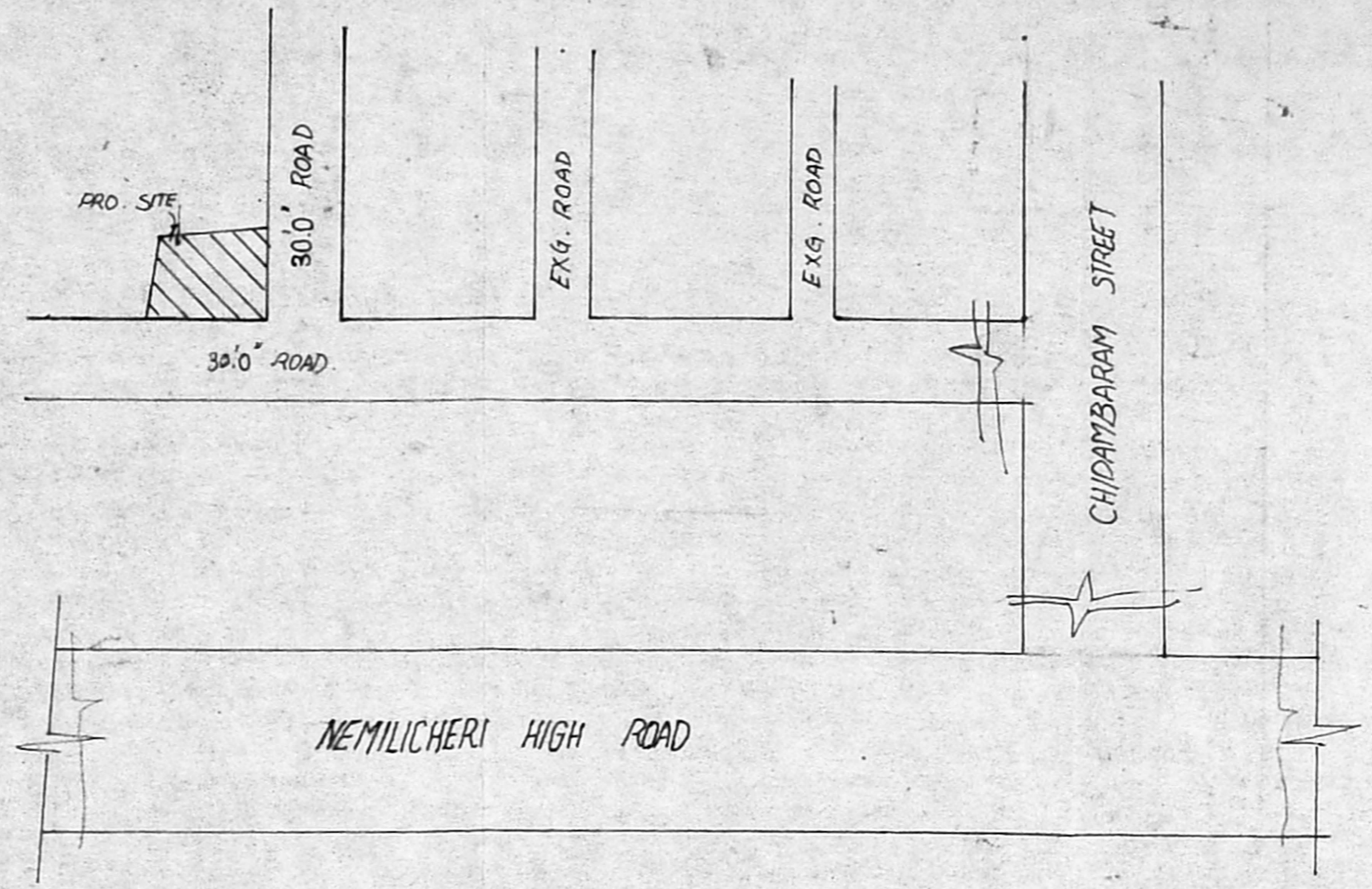

KEYPLAN NTS.

EXTENT	
PLOT AREA A	2463 SQFT. 228.81 SQ.M <sup>2</sup>
PLOT AREA B	1250 SQFT. 116.12 SQ.M <sup>2</sup>
TOTAL AREA	3713 SQFT. 344.93 SQ.M <sup>2</sup>

INDEX	
PROPOSAL	[Symbol]
BOUNDARY	[Symbol]
ROAD	[Symbol]

*[Signature]*  
 DWVER

*[Signature]*  
**F. Anwar Baig, D.C.E., D. Arch.**  
 Consulting Civil, Architect Engineer,  
 LICENSED SURVEYOR  
 Tambaram Municipality,  
 No. 202, Shanthi Nagar  
 CHROMEPET, MADRAS-600 044.  
 LICENSED SURVEYOR.